

Existing SVP to be located

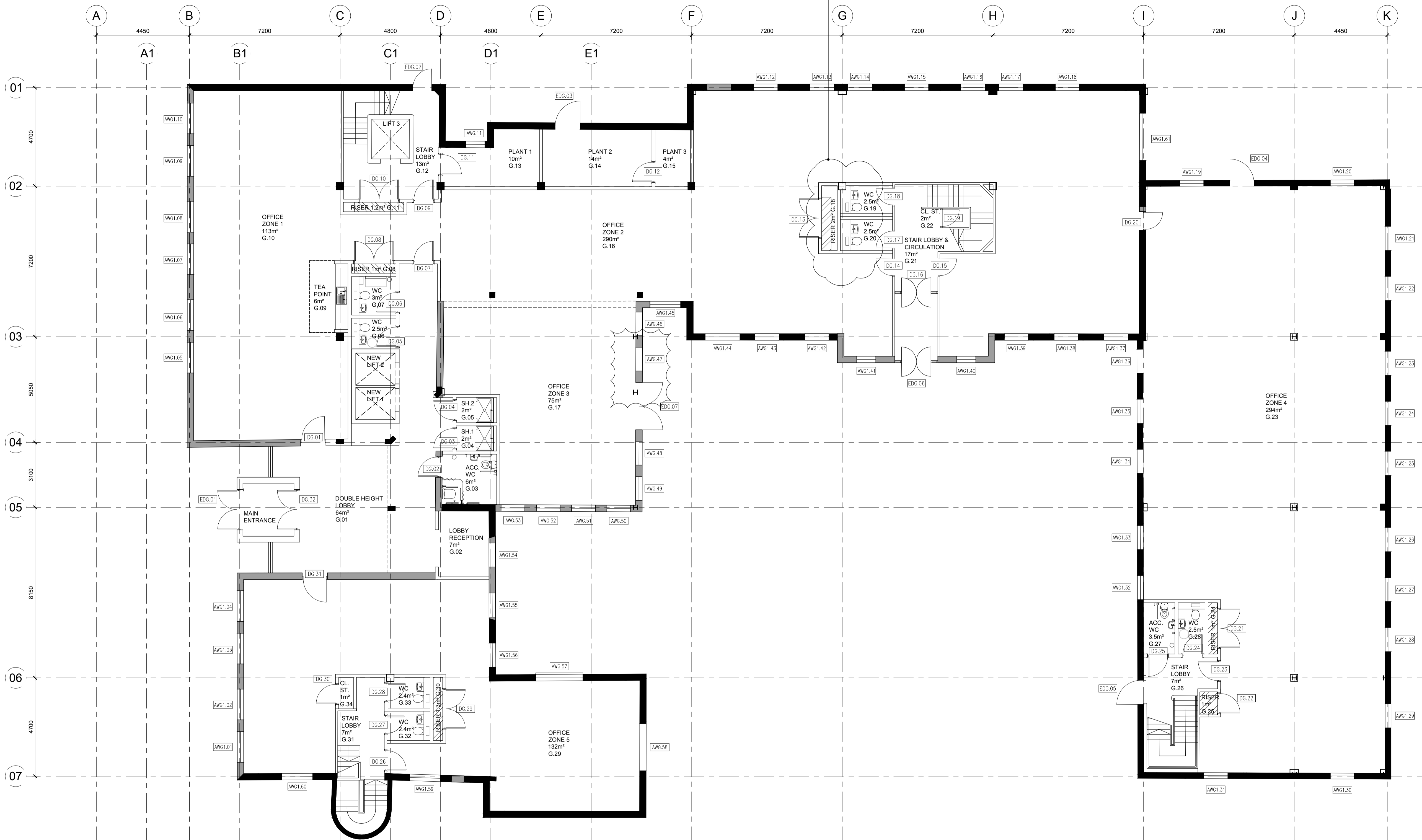
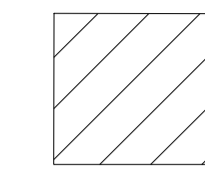
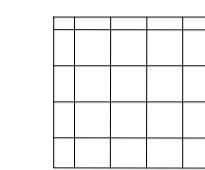
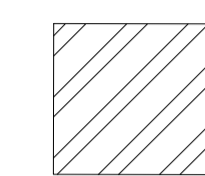

HATCH KEY:

-  Green roof
-  Maintenance only "terrace"
-  MEP Riser penetration area

ALL AREAS ARE APPROXIMATE & SUBJECT TO CHANGE FOLLOWING RECEIPT OF SURVEY INFORMATION

DRAWINGS SUBJECT TO RECEIPT OF SURVEY INFORMATION

P2b	30.06.17	STAGE 3 ISSUE	NM	CG
P2a	09.06.17	WC UPDATED TO COMMENTS, RISER & SERVICES POSITIONS ADDED IN ACCORDANCE WITH M&E INFORMATION, COLUMN POSITIONS COORDINATED WITH STRUCTURAL ENGINEER'S INFORMATION	NM	CG
P2	25.05.17	LIFT AREA LAYOUT AMENDED TO RBW&M COMMENTS.	NM	CG
P1	12.05.17	PRELIMINARY ISSUE	NM	CG
Rev	Date	Revision Details	Dr	Ch



ECE Architecture
 www.ecearchitecture.com
 London: 76 Great Suffolk Street, London, SE1 0BL
 T 0207 928 2773 E london@ecearchitecture.com
 Sussex: Brooklyn Chambers, 11 Goring Road, Worthing, West Sussex, BN12 4AP
 T 01903 248777 E sussex@ecearchitecture.com
 Bristol: Westworks, St. Nicholas House, 31-34 High Street, Bristol, BS1 2AW
 T 0117 315 8557 E bristol@ecearchitecture.com

Client's Name
WILLMOTT DIXON CONSTRUCTION

Job Title
ROYAL BOROUGH OF WINDSOR & MAIDENHEAD - YORK HOUSE

Drawing Title
PROPOSED GROUND FLOOR PLAN

Scale
1:100 @ A1 / 1:200 @ A3



Drawn: CG
Checked: PJ
Date: MAY '17

Job No: E551
Drawing No: ECE-V1-01-GA-A-01-0003
Rev: P2b

Status
INFORMATION